

DIMENSIONS mm (inches)

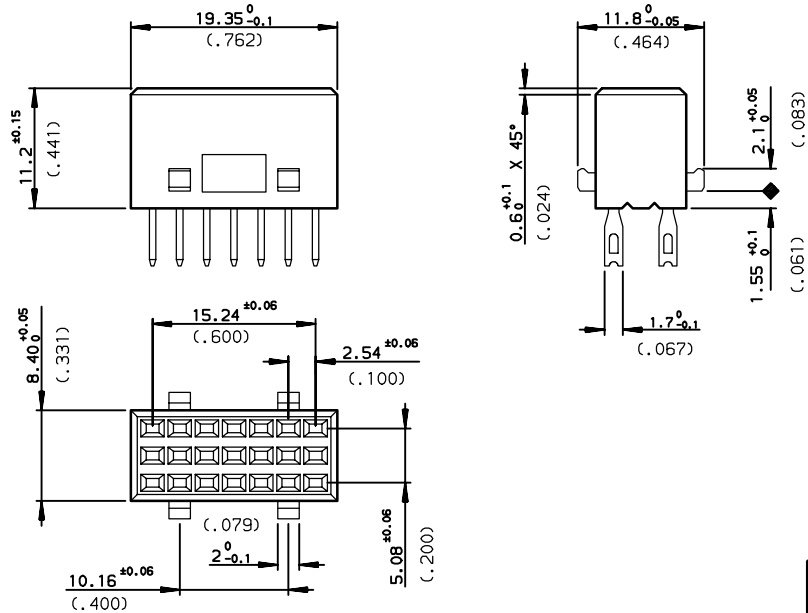

GENERAL CHARACTERISTICS AND ROHS INFORMATIONS:
SEE DRAWING C-8609-0000B

PART NUMBER	8609			40		3		5	
PIN OUT									
rows a-b-c									3 - 21
rows a-c									4 - 14
NUMBER OF CONTACTS									
TERMINATION									
L1 = 5.7 ±0.3 (.224)									short solder eyelet - 09
L2 = 13.7 ±0.3 (.539)									long solder eyelet - 10
L1 and L2									mixed solder eyelet - 08
PERFORMANCE CLASS									
DIN 41612 class 3									4
DIN 41612 class 2									6
DIN 41612 class 1									6
TERMINATION TYPE									
TIN LEAD									000E1
LEAD FREE									E1LF

TERMINATION

TYPE 09

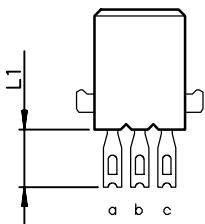

TYPE 10

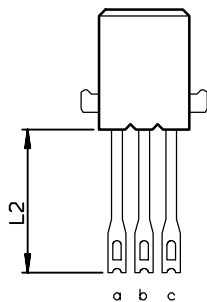

TYPE 08

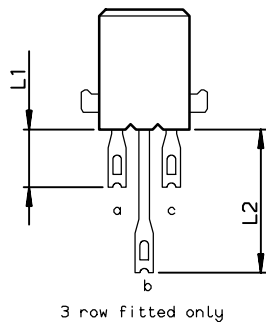

rev	ecn no	dr	date
B	-	ROU	2006/10/24
C	LS05-005	JTA	2005/03/17
D	LS06-0095	LGO	2006/06/22
-	-	-	-
-	-	-	-
-	-	-	-

www.fciconnect.com		surface ISO 1302	tolerance std ISO 406 ISO 1101	projection	mm
		TOLERANCES UNLESS OTHERWISE SPECIFIED			
Dr	ROUILLARD	1997/10/30	ANGULAR	0.X ±0.1	size A3
Eng	TARON	1997/10/30	LINEAR	0.XX ±0.1	Scale 2
Chr	LEGARE	1997/10/30	0.XX ±2*	0.XXX ±0.1	ECN LS06-0095
Appr	LEGARE	1997/10/30	Product family	DIN 8609	Spec ref -
FCJ		FEMALE MODULE 21 CONTACTS			Rev. D
		SOLDER EYELET			dwg no C-8609-0658
catalog no		-			CUSTOMER sheet 1 of 1

European Views

Copyright FCI.