

COUNT	DESCRIPTION OF REVISIONS	BY	CHKD	DATE	COUNT	DESCRIPTION OF REVISIONS	BY	CHKD	DATE
△					△				
△					△				
△					△				

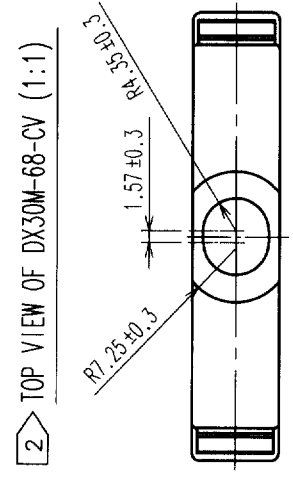
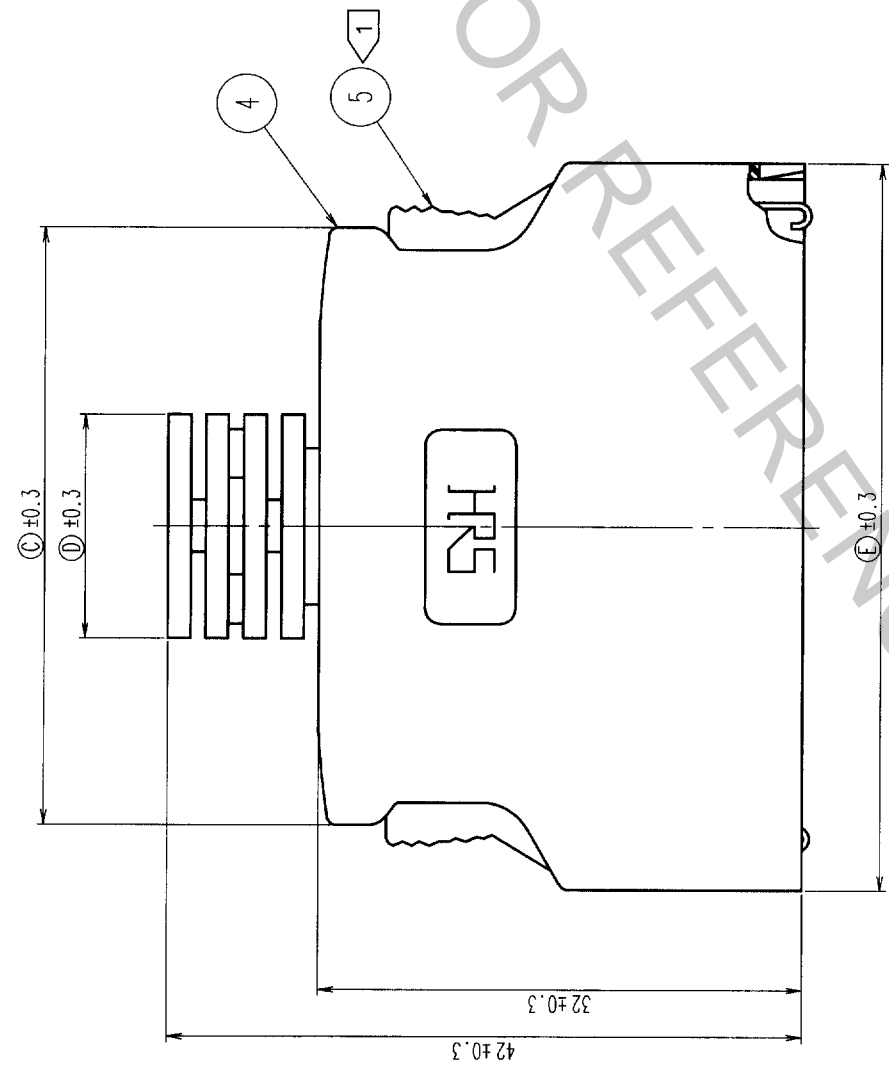
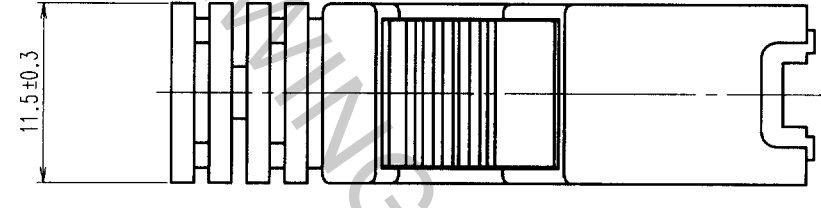
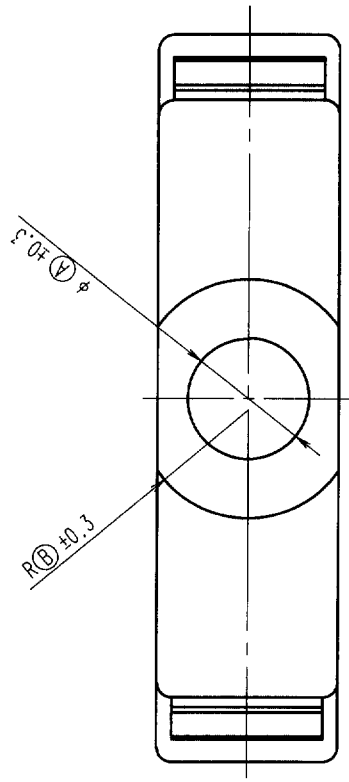

NOTE ① COMPONENTS OF REF. NO. ①, ②, ③ AND ⑤ ARE APPENDED.

PART NO.	PRODUCT CODE	①	②	③	④	⑤
DX30M-14-CV(10)	CL230-5051-7-10	6.30	5.75	17.09	11.50	25.79
DX30M-20-CV(10)	CL230-5052-0-10	6.70	7.25	20.90	14.50	29.60
DX30M-26-CV(10)	CL230-5053-2-10	7.10	7.25	24.80	15.00	33.50
DX30M-36-CV(10)	CL230-5054-5-10	8.10	7.25	31.06	15.75	39.80
DX30M-50-CV(10)	CL230-5055-8-10	8.70	7.25	39.95	16.00	48.70
DX30M-68-CV(10)	CL230-5056-0-10	②	②	51.38	17.57	60.13

NO.	MATERIAL	FINISH, REMARKS	NO.	MATERIAL	FINISH, REMARKS
2	STAINLESS STEEL		5	POLYCARBONATE	(LIGHT BEIGE) UL94V-2
1	STAINLESS STEEL		4	POLYCARBONATE	(LIGHT BEIGE) UL94V-2
			3	STAINLESS STEEL	

CODE NO. (OLD)	DRAWN	DESIGNED	CHECKED	APPROVED	RELEASED
	M. Shingama	M. Shingama	Y. Enami	H. Murao	
	02.4.8	02.4.8	02.4.8	02.04.09	

DRAWING NO.	EDC3-123778-01	PART NO.	DX30M-**-CV(10)
SCALE	2 : 1	CODE NO.	CL230
UNITS	mm		

TO	Q1		
----	----	--	--

HRS HIROSE ELECTRIC CO., LTD		FORM NO. 229	
------------------------------	--	--------------	--