

REV. NO.		REVISIONS			
NO.	DATE	DESCRIPTION	DATE	OWN	APPROV
CM	53				
C		REV PER EC 061B-0021-99	16-MAR-99	JH	RS

- PINS TO COMPLY WITH AMP SOLDERABILITY SPEC. 108-11-3.
- 0.00381 MIN MATTE TIN LEAD OVER 0.00127 MIN NICKEL.
- 0.00076 MIN GOLD PLATE IN THE LOCALIZED PLATE AREA, 0.00381 MATTE TIN LEAD IN THE LOCALIZED PLATE AREA, BOTH OVER 0.00127 MIN NICKEL.

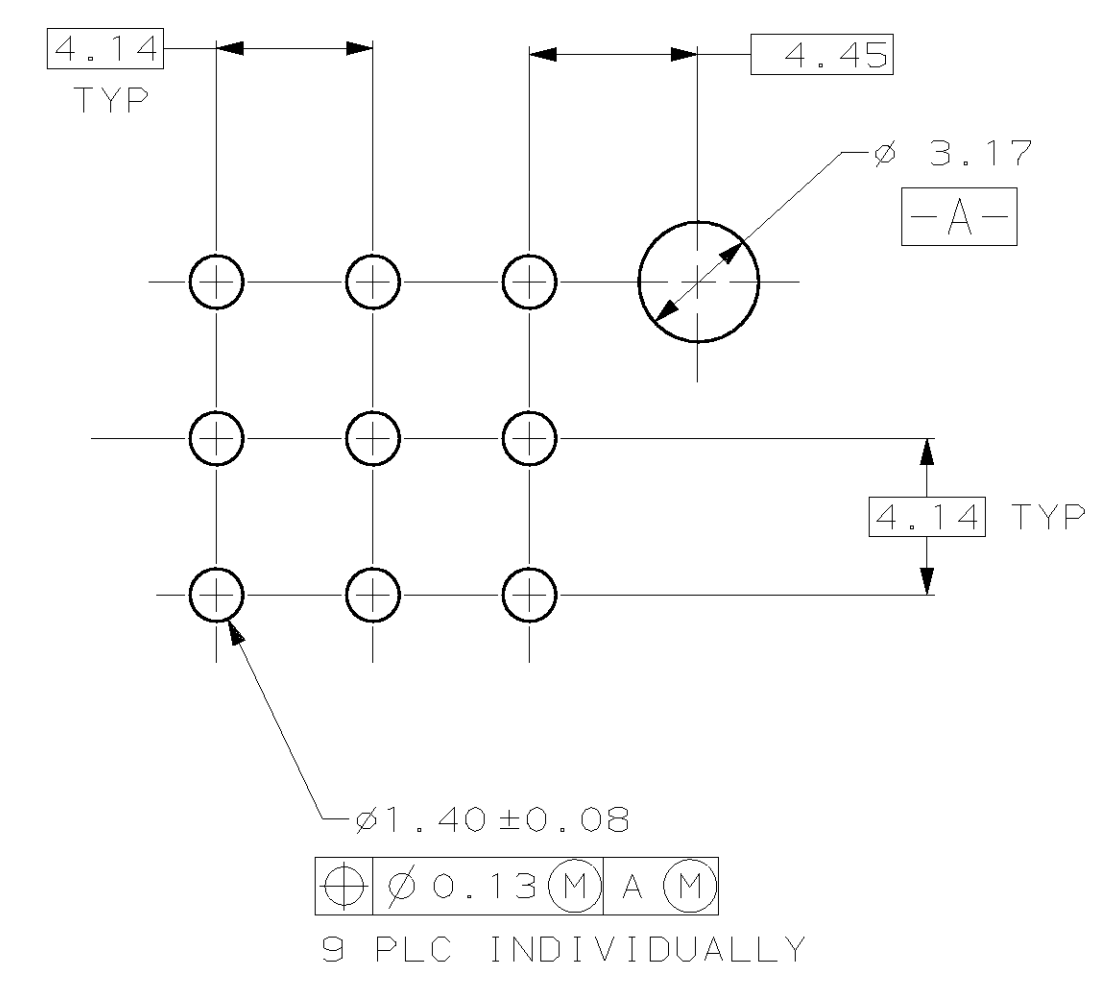

RECOMMENDED MOUNTING HOLE PATTERN FOR 1.57 THICK P.C. BOARD

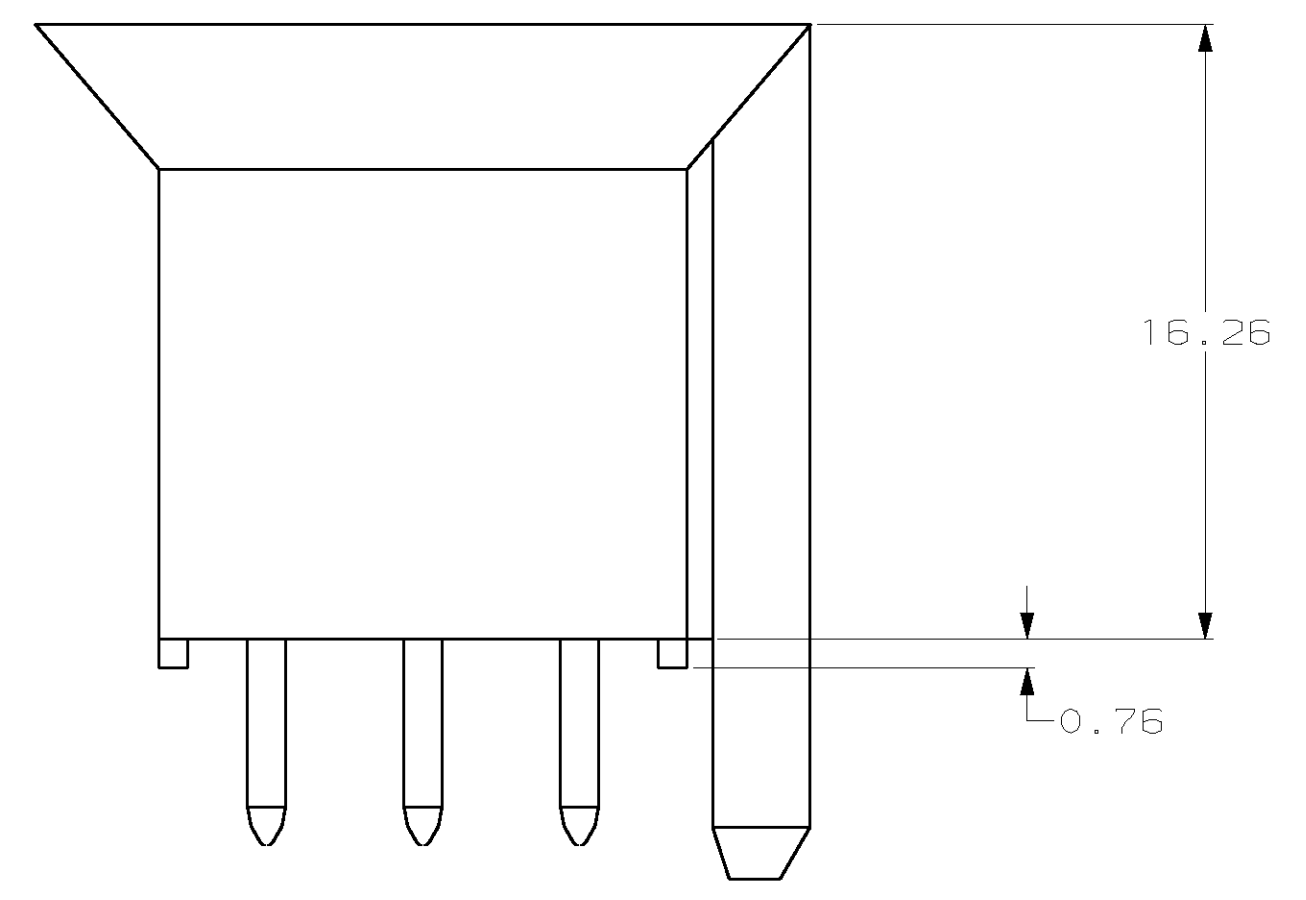
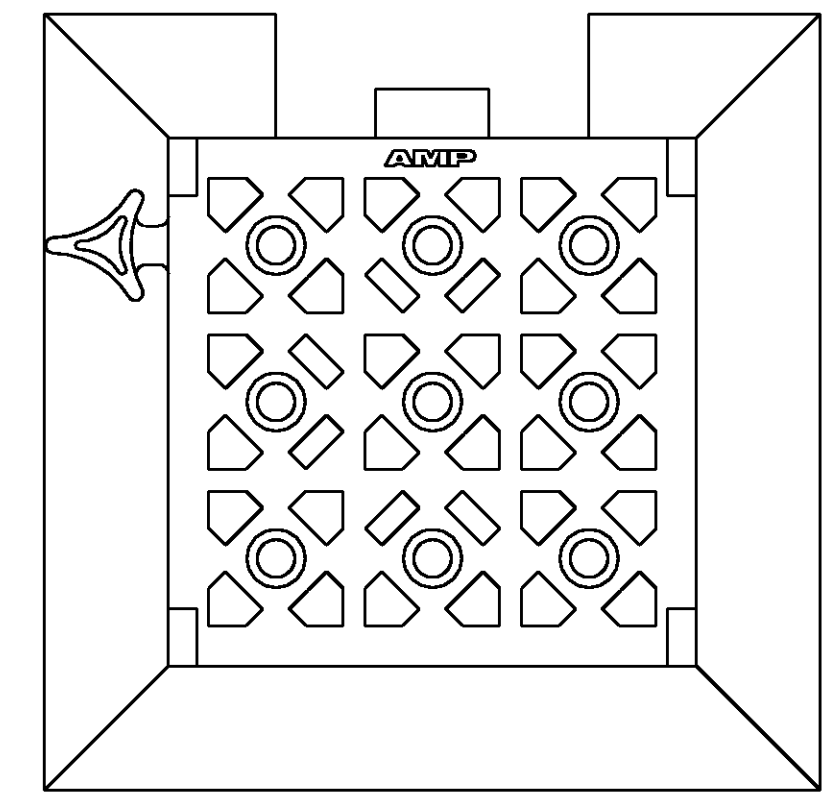
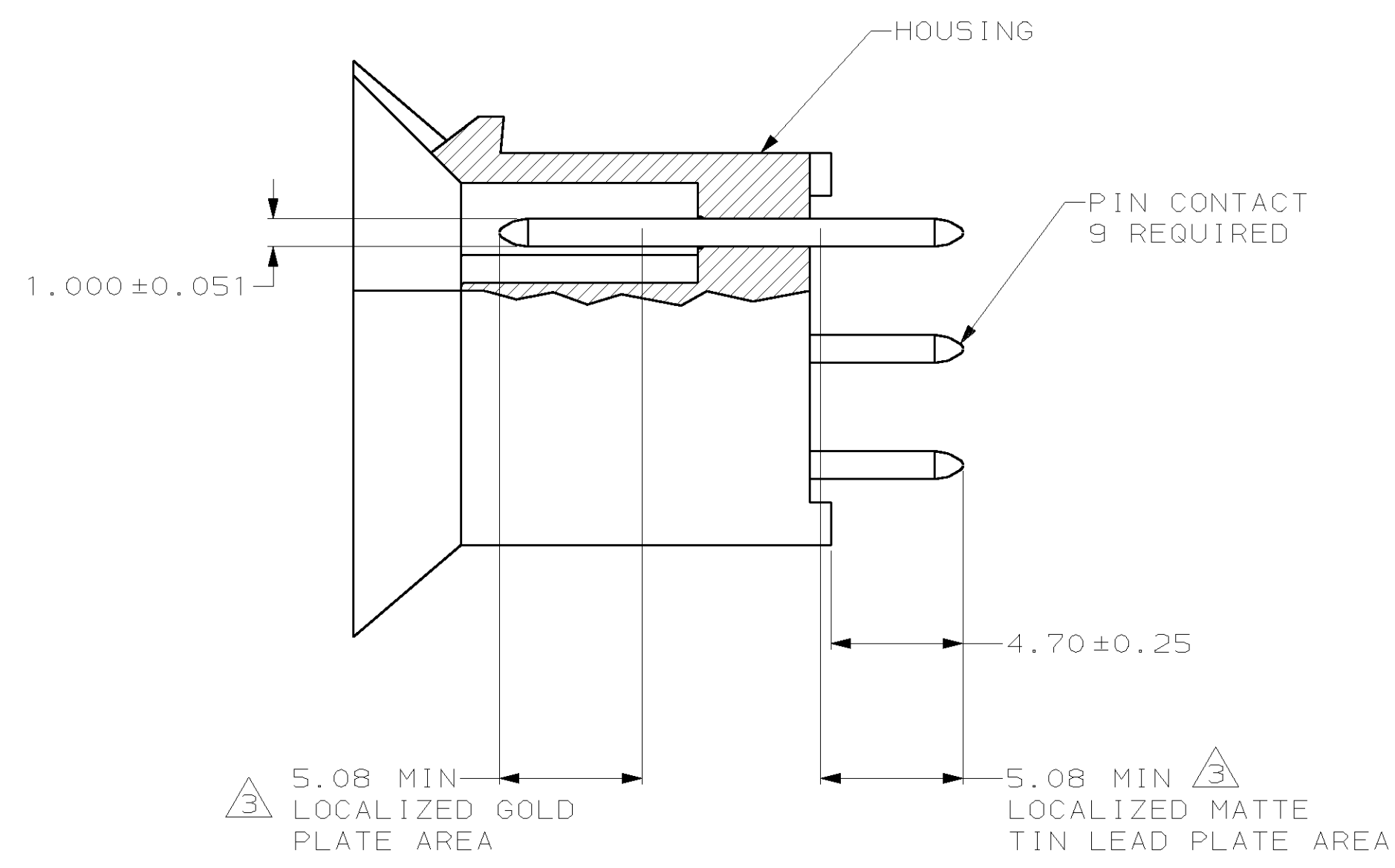
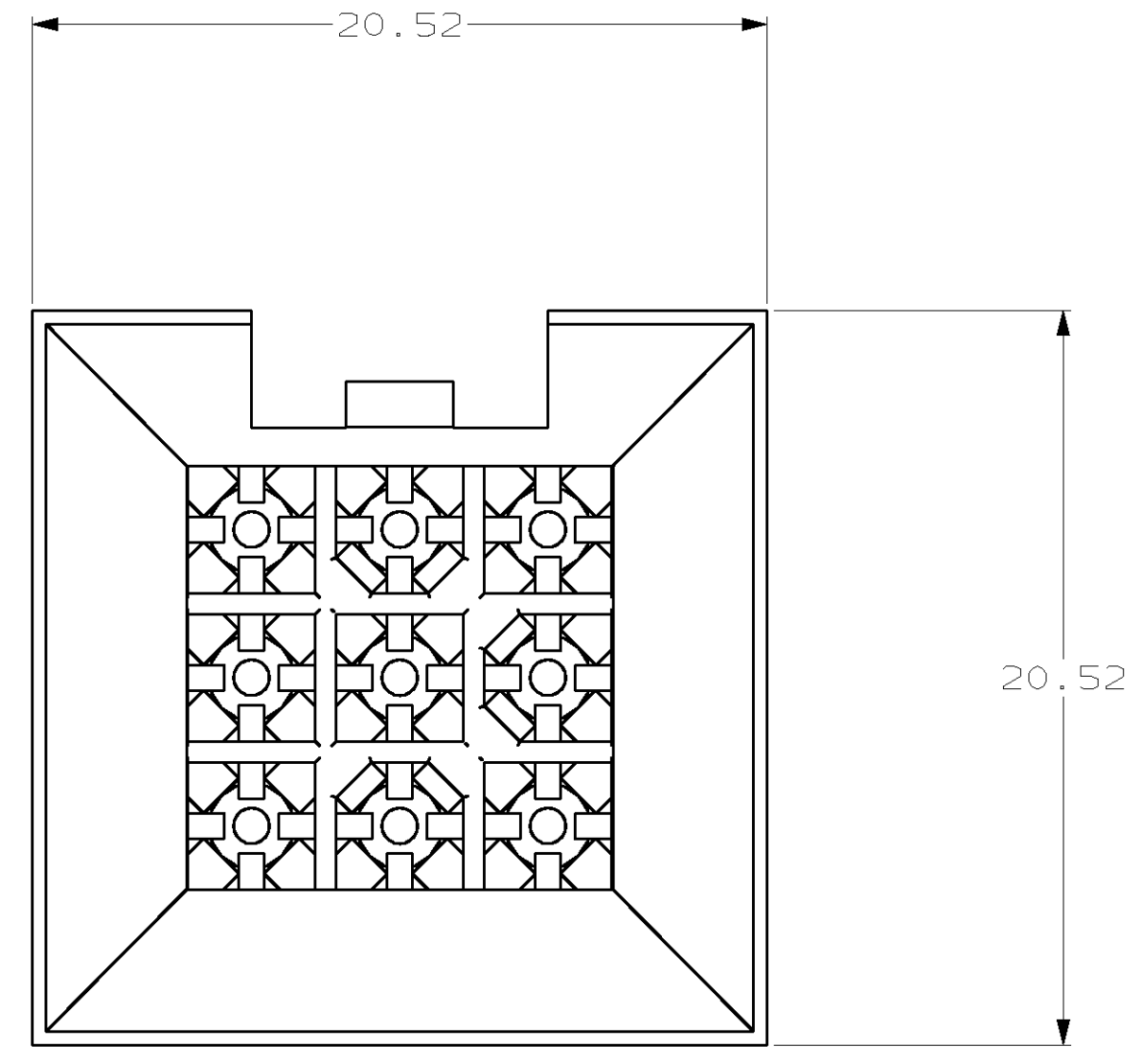
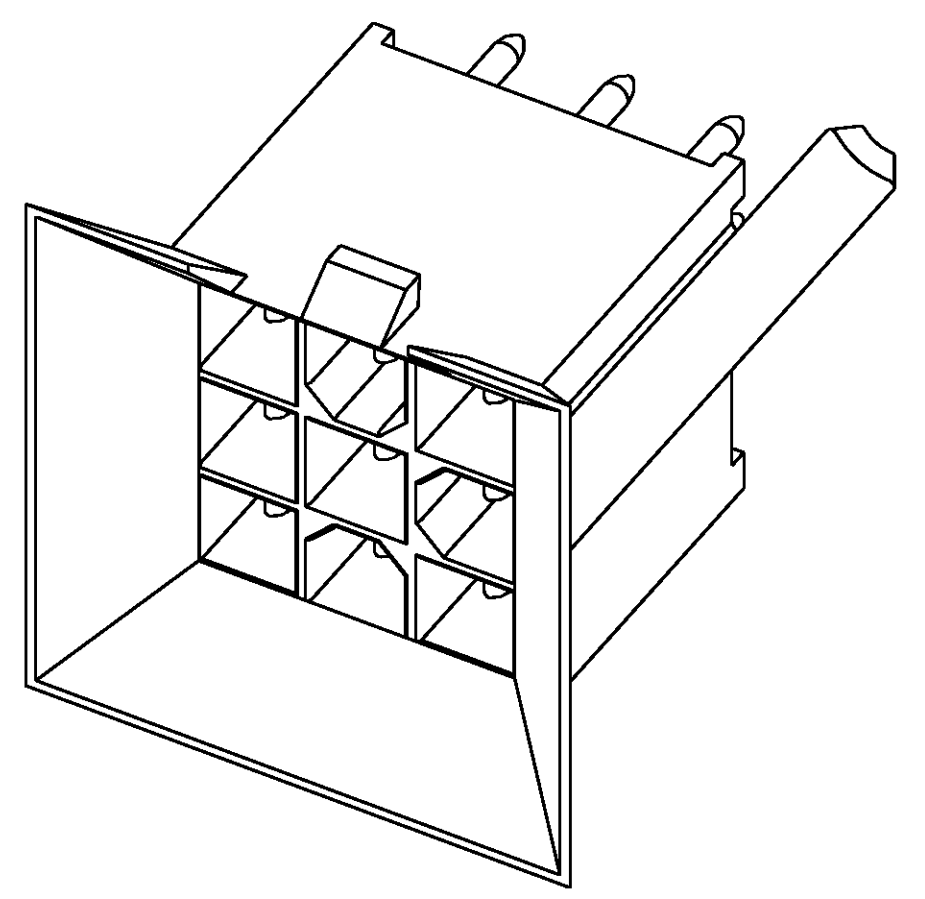

3-DIMENSIONAL MODEL NTS

MM	IN	MM	IN
1.000	.0394	20.52	.808
0.76	.030	16.26	.640
0.25	.010	5.08	.200
0.13	.005	4.70	.185
0.08	.003	4.45	.175
0.051	.0020	4.14	.163
0.00381	.000150	3.17	.125
0.00127	.000050	1.57	.062
0.00076	.000030	1.40	.055
MM	IN	MM	IN

CONVERSION TABLE



BRASS, GOLD	NYLON, 94V-0, WHITE	794130-2
BRASS, TIN LEAD	NYLON, 94V-0, WHITE	794130-1
PIN CONTACT MATERIAL AND FINISH	HOUSING MATERIAL AND COLOR	PART NUMBER
<small>THIS DRAWING IS A CONTROLLED DOCUMENT AND THE INFORMATION CONTAINED HEREIN IS SUBJECT TO CHANGE AND THE CONTROLLING ENGINEERING DEPARTMENT SHALL BE CONTACTED FOR THE LATEST REVISION.</small>		DWN: K. WHITAKER 10-14-96 CHK: R. SWING 10-14-96 APP'D: R. ORSTAD 10-14-96 DATE: 10-14-96
DIMENSIONS: mm TOLERANCES UNLESS OTHERWISE SPECIFIED: 0 PLC ±.013 1 PLC ±.013 2 PLC ±.013 3 PLC ±.013 4 PLC ±.013 ANGLES ±.013		AMP Incorporated Harrisburg, PA 17105-3608 AMP HEADER ASSEMBLY, BLIND MATE, 9 CIRCUIT, MINI-UNIVERSAL MATE-N-LOK™
MATERIAL: SEE TABLE	FINISH: SEE TABLE	SIZE: A1 CAGE CODE: 00779 DRAWING NO: C=794130 SCALE: 5:1 SHEET: 1 of 1 REV: C
CUSTOMER DRAWING		